

Power Flame® Type C

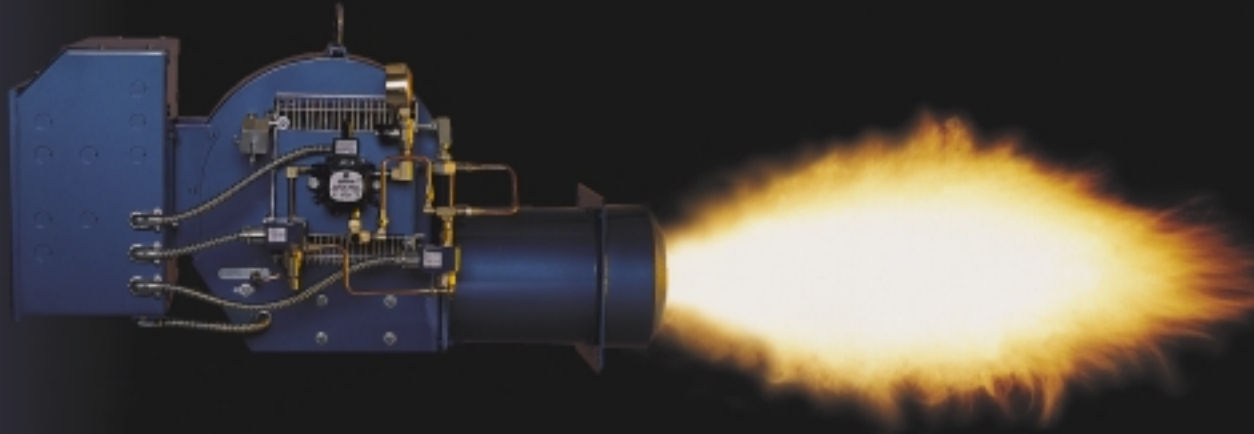

Power Flame's Versatile High Performance Light Oil Burner

The Power Flame Model CO oil burner presents optimum state-of-the-art design for maximum combustion efficiency and operating dependability. These packaged combustion systems will fire a wide range of liquid fuels within the #2 fuel oil viscosity range. The flame retention firing head incorporates a single nozzle pressure atomizing oil assembly and unique air distribution design to produce full range stable performance in both positive and negative combustion chambers. Operating system adjustments have been minimized to provide trouble-free start up and

operating performance.

The Model CO produces efficient combustion without the aid of refractory or other costly flame support devices. The integrally mounted, high velocity air fan produces high turbulence in the flame propagation zone and the resultant compact flame expands application within limited size combustion chamber configurations. Modular design produces added flexibility for a wide range of optional features. All Power Flame packaged combustion systems are factory fire-tested to ensure cost effective installation and start up.

Mounting Flange Flexibility
Easily adapted to varying firing head insertion depths

Circular Furnace Opening
No special cutting of combustion chamber front plate

Characterized Fuel Metering
Varicam® provides adjustable and accurately repeatable fuel-air ratios throughout the firing range*

Total Access Panel
Swing out, easily removable top and front panels give total access to all internal panel-mounted components

Alpha System™
LED indicators, switches and operator annunciator. (Optional additional 6-light board shown on right.)

Graphic Burner Management System
Director® graphic annunciation of critical burner functions*

*Optional



Power Flame

The Power to Manage Energy

Alternate COS configuration incorporates simplified control package with Cadmium Sulfide sensing system.



STANDARD EQUIPMENT

- 3450 RPM Motor, squirrel cage blower, oil valves, nozzle assembly, direct spark ignition*
- Alpha System™ LED indicator (power, demand, main fuel, FSG alarm, selectable) and control switch**

ADDED FEATURES

X-Standard O-Optional NA-Not Available

- Flame Safeguard with cadmium sulfide cell
- Flame Safeguard with UV and prepurge
- Flame Safeguard with UV, prepurge and postpurge
- On-Off with fixed air control - manual adjustment
- Low-High-Off or Low-High-Low with automatic air control
- Modulation with automatic air control
- Integral 2-stage fuel unit, C1-0(S), C2-OB(S) single stage
- Remote mounted 2-stage fuel unit (single stage for C6-C8) (C)
- Dual oil safety valves
- Customized control systems and accessories
- Man/Auto switch - manual potentiometer - modulation units

* Gas pilot ignition furnished as standard on C4-OB, C5-0(B), C6-0, C7-0, C8-0
 ** Not furnished on C1-OS, C2-OAS, C2-OBS

C1-OS C2-OAS	C2-OBS (A)	C1-0 C2-0A	C2-OB	C3-0 C3-OB	C4-0A	C4-OB C5-0(B)	C6-0	C7-0 C8-0
X	X	X	(A) X	NA	NA	NA	NA	NA
NA	NA	O	(A) O	NA	NA	NA	NA	NA
NA	NA	O	(B) O	X	X	X	X	X
X	NA	X	NA	NA	NA	NA	NA	NA
O	X	O	X	X	X	NA	NA	NA
NA	NA	O	O	O	O	X	X	X
X	X	X	X	X	X	NA	NA	NA
NA	NA	O	O	O	O	X	X	X
X	X	X	X	X	X	X	X	X
NA	NA	O	O	O	O	O	O	O
NA	NA	X	X	X	X	X	X	X

(A) 20 GPH or less

(B) Standard above 20 GPH

(C) Additional UL code features required

MODEL CR (For low centerline applications)

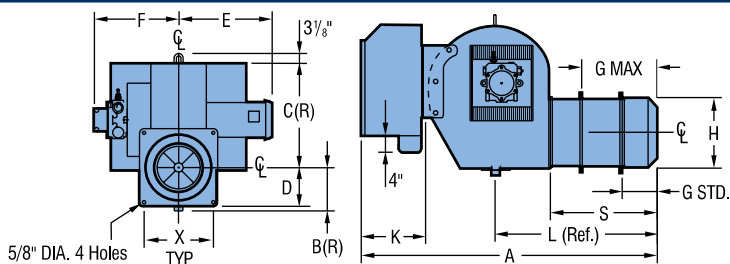

Add 3/8" to "H" for size of opening in boiler front plate

MODEL C

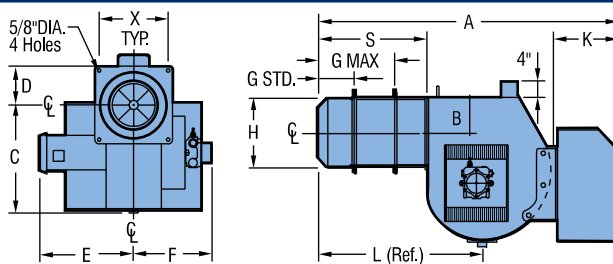

Add 3/8" to "H" for size of opening in boiler front plate

DIMENSIONS (Inches) Standard Models

NOTE: Dimensions vary with mode of operation. Maximum dimensions are shown. For COS burner, deduct 6" from "A" dimension. "A" dimension may be reduced by 10 1/4" by moving panel to appropriate alternate location.

Burner Model	A	B	B(R)	C	C(R)	D	E	F	G Std.	G Max.*	G CAD	H	K	L	S	X	CAPACITY ¹		Blower Motor H.P. (3450 RPM)	Pressure Pump Suction Capacity (GPH)
																	#2 Oil GPH Max.	Nominal Boiler H.P. Max.		
C1-0(S)	34 1/8	3 13/16	5 9/16	14 1/2	14 1/2	4 5/8	12 1/4	12 3/4	3 1/4	4 3/4	11	7 1/4	10 1/4	17 1/8	12 5/8	7 1/4	9.7	32.3	1/3	†19
C2-0A(S)	39 1/8	4 1/2	6 1/8	14 7/8	14	5 1/4	14	13	4	6 3/4	11 1/2	8 3/4	10 1/4	18 7/8	13 3/8	8 1/2	15.7	52.3	3/4	†70
C2-OB(S)	39 1/8	4 1/2	6 1/8	14 7/8	14	5 1/4	14	13	4	6 3/4	11 1/2	8 3/4	10 1/4	18 7/8	13 3/8	8 1/2	22.0	73.5	1 1/2	70
C3-0	44	5 1/4	7	16 5/8	15 1/4	6	16	14 1/4	4 1/2	8	-	10 1/8	10 1/4	22	15 1/2	10	33.7	112.0	2	105
C3-OB	44	5 1/4	7	16 5/8	15 1/4	6	16	14 1/4	4 1/2	8	-	10 1/8	10 1/4	22	15 1/2	10	37.5	125.0	3	135
C4-0A	50	6 1/4	7 5/16	18 7/8	17 11/16	7	18 1/2	18	6	9	-	12 1/8	10 1/4	26 5/8	19 1/8	12	45.0	150.0	5	135
C4-OB	50	6 1/4	7 5/16	18 7/8	17 11/16	7	18 1/2	18	6	9	-	12 1/8	10 1/4	26 5/8	19 1/8	12	56.0	190.0	5	†135
C5-0	50	6 1/4	7 5/16	18 7/8	17 11/16	7	18 1/2	18	6	9	-	12 1/8	10 1/4	26 5/8	19 1/8	12	75.0	250.0	7 1/2	†250
C5-OB	50	6 1/4	7 5/16	18 7/8	17 11/16	7	18 1/2	18	6	9	-	12 1/8	10 1/4	26 5/8	19 1/8	12	75.0	250.0	7 1/2	†250
C6-0	49 7/8	6 1/4	7 5/16	18 7/8	17 11/16	7 3/4	19 7/8	18	5	11 3/4	-	13 5/8	10 1/4	26 1/2	19	13 1/2	101.5	340.0	10	†250
C7-0	51 11/16	8 1/8	10 1/8	24 5/16	22 3/8	8 3/4	18	18	4 7/8	11 1/4	-	15 5/8	9 1/8	26 1/2	19	13 1/2	121.4	404.0	15	235
C7-OB	51 11/16	8 1/8	10 1/8	24 5/16	22 3/8	8 3/4	18	18	4 7/8	11 1/4	-	15 5/8	9 1/8	26 1/2	19	13 1/2	126.4	421.0	20	235
C8-0	56 9/16	8 1/8	10 1/8	27 1/8	27 5/8	8 3/4	20	18	3 1/4	9 5/8	-	15 5/8	9 1/8	24 7/8	17 5/16	13 1/2	136.4	454.0	15	235

RATINGS & SPECIFICATIONS



Power Flame Incorporated

2001 South 21st Street Phone 620-421-0480
 Parsons, KS 67357 Fax 620-421-0948

Web Site: <http://www.powerflame.com>
 E-Mail: csd@powerflame.com

Copyright © Power Flame Incorporated 2004 Printed in U.S.A.

¹ Capacities listed are based on 0.20" W.C. positive pressure, except for C5-OB, which is rated for 250 BPH at +1.2" W.C. Derate capacities approximately 5% for each +0.50" W.C. combustion chamber pressure. For C7/C8 derate see capacity curves. C1-0(S) requires optional 1/2 HP motor for 9.7 GPH rate.

† Remote Pump Set with 200 (208) or 230/460/3/60 motor, 3450 RPM - 3/4 HP - C4; 1750 RPM - 1 HP - C5, C6; 1750 RPM 1 1/2 HP - C7, C8.

†† For On-Off and modulating firing modes only. Refer to C Manual for capacities on other modes.

* This dimension may be increased. Consult factory.